

CrazyMill Frontchamfer

RACCOMANDAZIONI PER L'USO

● Perfettamente consigliato | ● Consigliato | ○ Parzialmente consigliato | ☒ Non consigliato

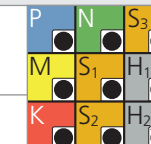

SBAVARE CON RAFFREDDAMENTO ESTERNO | VISTA D'INSIEME DEI DATI DI TAGLIO

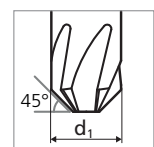
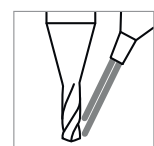

Gruppo materiali	Materiale	Mat. no.	DIN	AISI/ASTM/UNS	v _c [m/min]	f _z [mm]	
						Ød1	
						1.0 - 2.0 mm f _z	3.0 - 6.0 mm f _z
P	Acciai non legati Rm < 800 N/mm ²	1.0301	C10	AISI 1010	120	0.01 - 0.04	0.03 - 0.05
		1.0401	C15	AISI 1015			
		1.1191	C45E/CK45	AISI 1045			
		1.0044	S275JR	AISI 1020			
		1.0715	11SMn30	AISI 1215			
	Acciai debolmente legati Rm > 900 N/mm ²	1.5752	15NiCr13	ASTM 3415 / AISI 3310	100	0.01 - 0.03	0.02 - 0.04
		1.7131	16MnCr5	AISI 5115			
		1.3505	100Cr6	AISI 52100			
		1.7225	42CrMo4	AISI 4140			
		1.2842	90MnCrV8	AISI O2			
	Acciai da utensili fortemente legati Rm < 1200 N/mm ²	1.2379	X153CrMoV12	AISI D2	80	0.01 - 0.02	0.01 - 0.03
		1.2436	X210CrW12	AISI D4/D6			
1.3343		HS6-5-2C	AISI M2 / UNS T11302				
1.3355		HS18-0-1	AISI T1 / UNS T12001				
M	Acciai inossidabili ferritici	1.4016	X6Cr17	AISI 430 / UNS S43000	50	0.01 - 0.02	0.02 - 0.03
		1.4105	X6CrMoS17	AISI 430F			
	Acciai inossidabili martensitici	1.4034	X46Cr13	AISI 420C	80	0.01 - 0.02	0.01 - 0.03
		1.4112	X90CrMoV18	AISI 440B			
	Acciai inossidabili martensitici - PH	1.4542	X5CrNiCuNb 16-4	AISI 630 / ASTM 17-4 PH	50	0.01 - 0.02	0.02 - 0.03
		1.4545	X5CrNiCuNb 15-5	ASTM 15-5 PH			
	Acciai inossidabili austenitici	1.4301	X5CrNi 18-10	AISI 304			
		1.4435	X2CrNiMo 18-14-3	AISI 316L			
1.4441		X2CrNiMo 18-15-3	AISI 316LM				
1.4539		X1NiCrMoCu 25-20-5	AISI 904L				
K	Ghise	0.6020	GG20	ASTM 30	60	0.01 - 0.02	0.01 - 0.03
		0.6030	GG30	ASTM 40B			
		0.7040	GGG40	ASTM 60-40-18			
		0.7060	GGG60	ASTM 80-60-03			
N	Leghe d'alluminio battute	3.2315	AlMgSi1	ASTM 6351	200	0.02 - 0.05	0.03 - 0.07
		3.4365	AlZnMgCu1.5	ASTM 7075			
	Leghe d'alluminio pressofuse	3.2163	GD-AlSi9Cu3	ASTM A380	200	0.02 - 0.05	0.03 - 0.07
		3.2381	GD-AlSi10Mg	UNS A03590			
	Rame	2.004	Cu-OF / CW008A	UNS C10100	40	0.01 - 0.02	0.02 - 0.03
		2.0065	Cu-ETP / CW004A	UNS C11000			
	Ottoni senza piombo	2.0321	CuZn37 CW508L	UNS C27400	40	0.01 - 0.02	0.02 - 0.03
		2.036	CuZn40 CW509L	UNS C28000			
	Ottoni, Bronzi Rm < 400 N/mm ²	2.0401	CuZn39Pb3 / CW614N	UNS C38500	200	0.02 - 0.05	0.03 - 0.07
		2.102	CuSn6	UNS C51900			
Bronzi Rm < 600 N/mm ²	2.0966	CuAl10Ni5Fe4	UNS C63000	200	0.02 - 0.05	0.03 - 0.07	
	2.096	CuAl9Mn2	UNS C63200				
S ₁	Super leghe	2.4856		Inconel 625	40	0.01 - 0.02	0.02 - 0.03
		2.4668		Inconel 718			
		2.4617	NiMo28	Hastelloy B-2			
		2.4665	NiCr22Fe18Mo	Hastelloy X			
S ₂	Titanio puro	3.7035	Gr.2	ASTM B348 / F67	40	0.01 - 0.02	0.02 - 0.03
		3.7065	Gr.4	ASTM B348 / F68			
S ₃	Leghe di titanio	3.7165	TiAl6V4	ASTM B348 / F136	40	0.01 - 0.02	0.02 - 0.03
		9.9367	TiAl6Nb7	ASTM F1295			
H ₁	Acciai temprati < 55 HRC	2.4964	CoCr20W15Ni	Haynes 25	50	0.01 - 0.02	0.02 - 0.03
			CrCoMo28	ASTM F1537			
H ₂	Acciai temprati ≥ 55 HRC	1.2510	100MnCrMoW4	AISI O1	60	0.01 - 0.02	0.01 - 0.03
		1.2379	X153CrMoV12	AISI D2			