

# CrazyMill Backchamfer 3 x d / 5 x d

RACCOMANDAZIONI PER L'USO

● Perfettamente consigliato | ● Consigliato | ○ Parzialmente consigliato | ☒ Non consigliato

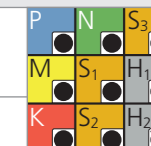

## SBAVARE CON RAFFREDDAMENTO ESTERNO | VISTA D'INSIEME DEI DATI DI TAGLIO

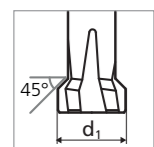
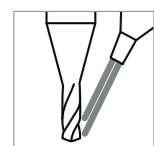

Gruppo materiali	Materiale	Mat. no.	DIN	AISI/ASTM/UNS	v <sub>c</sub> [m/min]	f <sub>z</sub> [mm]					
						Ød1					
						0.36 - 1.90 mm f <sub>z</sub>	2.90 - 5.70 mm f <sub>z</sub>				
P	Acciai non legati Rm < 800 N/mm <sup>2</sup>	1.0301	C10	AISI 1010	120	0.030	0.040				
		1.0401	C15	AISI 1015							
		1.1191	C45E/CK45	AISI 1045							
		1.0044	S275JR	AISI 1020							
		1.0715	11SMn30	AISI 1215							
		1.5752	15NiCr13	ASTM 3415 / AISI 3310							
	Acciai debolmente legati Rm > 900 N/mm <sup>2</sup>	1.7131	16MnCr5	AISI 5115	100	0.020	0.030				
		1.3505	100Cr6	AISI 52100							
		1.7225	42CrMo4	AISI 4140							
		1.2842	90MnCrV8	AISI O2							
		1.2379	X153CrMoV12	AISI D2							
		1.2436	X210CrW12	AISI D4/D6							
Acciai da utensili fortemente legati Rm < 1200 N/mm <sup>2</sup>	1.3343	HS6-5-2C	AISI M2 / UNS T11302	80	0.015	0.030					
	1.3355	HS18-0-1	AISI T1 / UNS T12001								
	M	Acciai inossidabili ferritici	1.4016				X6Cr17	AISI 430 / UNS S43000	50	0.010	0.030
			1.4105				X6CrMoS17	AISI 430F			
			1.4034				X46Cr13	AISI 420C			
	Acciai inossidabili martensitici	1.4112	X90CrMoV18				AISI 440B	80	0.015	0.030	
Acciai inossidabili martensitici - PH		1.4542	X5CrNiCuNb 16-4	AISI 630 / ASTM 17-4 PH							
		1.4545	X5CrNiCuNb 15-5	ASTM 15-5 PH							
Acciai inossidabili austenitici	1.4301	X5CrNi 18-10	AISI 304	50	0.015	0.030					
	1.4435	X2CrNiMo 18-14-3	AISI 316L								
	1.4441	X2CrNiMo 18-15-3	AISI 316LM								
	1.4539	X1NiCrMoCu 25-20-5	AISI 904L								
	K	Ghise	0.6020				GG20	ASTM 30	60	0.015	0.030
0.6030			GG30	ASTM 40B							
0.7040			GGG40	ASTM 60-40-18							
0.7060			GGG60	ASTM 80-60-03							
N			Leghe d'alluminio battute	3.2315	AlMgSi1	ASTM 6351	200	0.030			
	3.4365	AlZnMgCu1.5		ASTM 7075							
	Leghe d'alluminio pressofuse	3.2163	GD-AlSi9Cu3	ASTM A380	200	0.030	0.040				
		3.2381	GD-AlSi10Mg	UNS A03590							
	Rame	2.004	Cu-OF / CW008A	UNS C10100	40	0.020	0.030				
		2.0065	Cu-ETP / CW004A	UNS C11000							
	Ottoni senza piombo	2.0321	CuZn37 CW508L	UNS C27400	40	0.020	0.030				
		2.036	CuZn40 CW509L	UNS C28000							
	Ottoni, Bronzi Rm < 400 N/mm <sup>2</sup>	2.0401	CuZn39Pb3 / CW614N	UNS C38500	200	0.030	0.040				
		2.102	CuSn6	UNS C51900							
	Bronzi Rm < 600 N/mm <sup>2</sup>	2.0966	CuAl10Ni5Fe4	UNS C63000	200	0.030	0.040				
		2.096	CuAl9Mn2	UNS C63200							
S <sub>1</sub>	Super leghe	2.4856		Inconel 625	40	0.020	0.030				
		2.4668		Inconel 718							
		2.4617	NiMo28	Hastelloy B-2							
		2.4665	NiCr22Fe18Mo	Hastelloy X							
S <sub>2</sub>	Titanio puro	3.7035	Gr.2	ASTM B348 / F67	40	0.020	0.030				
		3.7065	Gr.4	ASTM B348 / F68							
S <sub>3</sub>	Leghe di titanio	3.7165	TiAl6V4	ASTM B348 / F136	40	0.020	0.030				
		9.9367	TiAl6Nb7	ASTM F1295							
H <sub>1</sub>	Acciai temprati < 55 HRC	2.4964	CoCr20W15Ni	Haynes 25	50	0.015	0.030				
			CrCoMo28	ASTM F1537							
H <sub>2</sub>	Acciai temprati ≥ 55 HRC	1.2510	100MnCrMoW4	AISI O1	60	0.015	0.020				
		1.2379	X153CrMoV12	AISI D2							